

ORIGINAL CAD
DESIGNS & DRAWINGS
BY
BOB GREINER
©2002

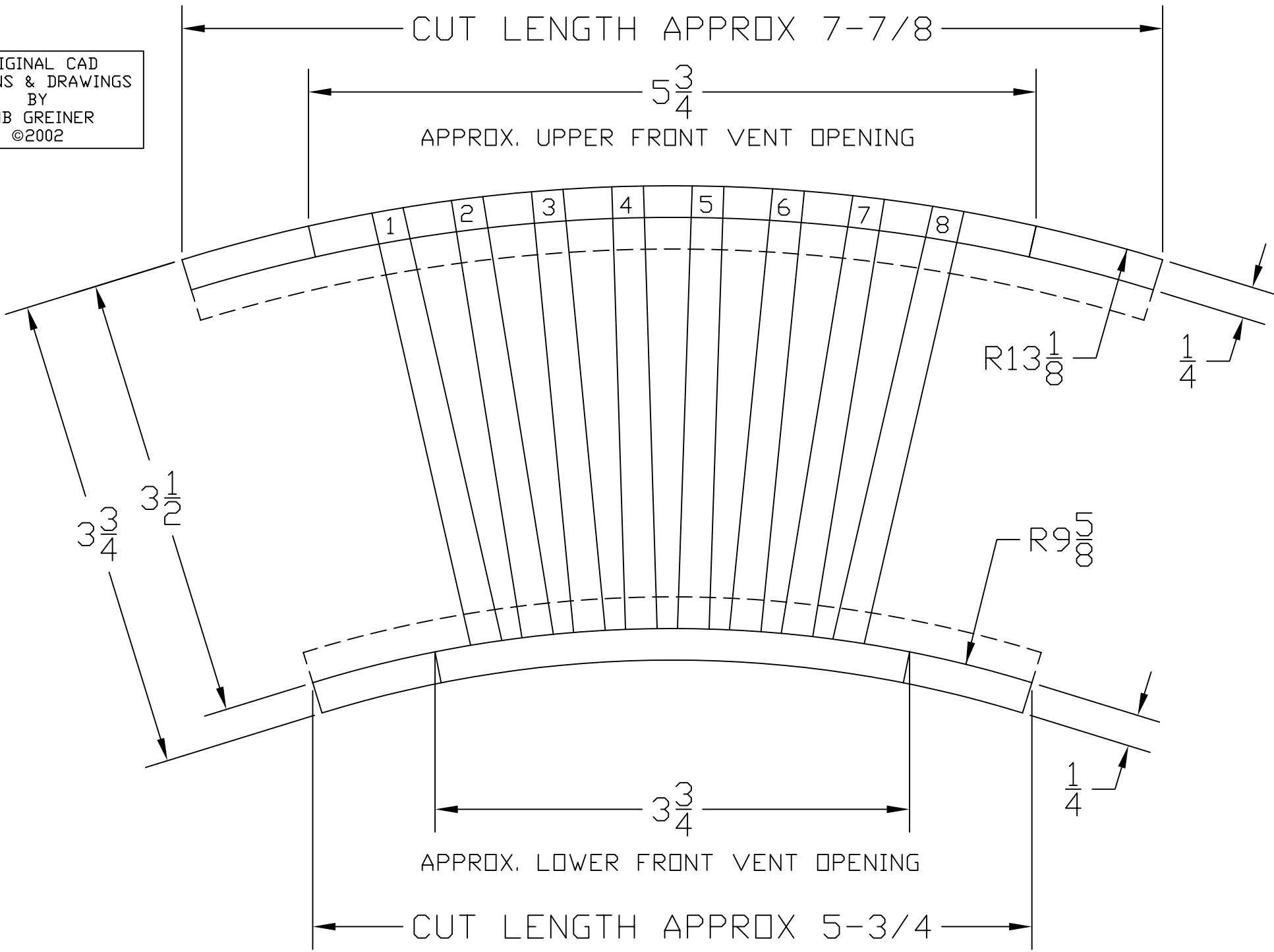

ORIGINAL CAD
DESIGNS & DRAWINGS
BY
BOB GREINER
©2002

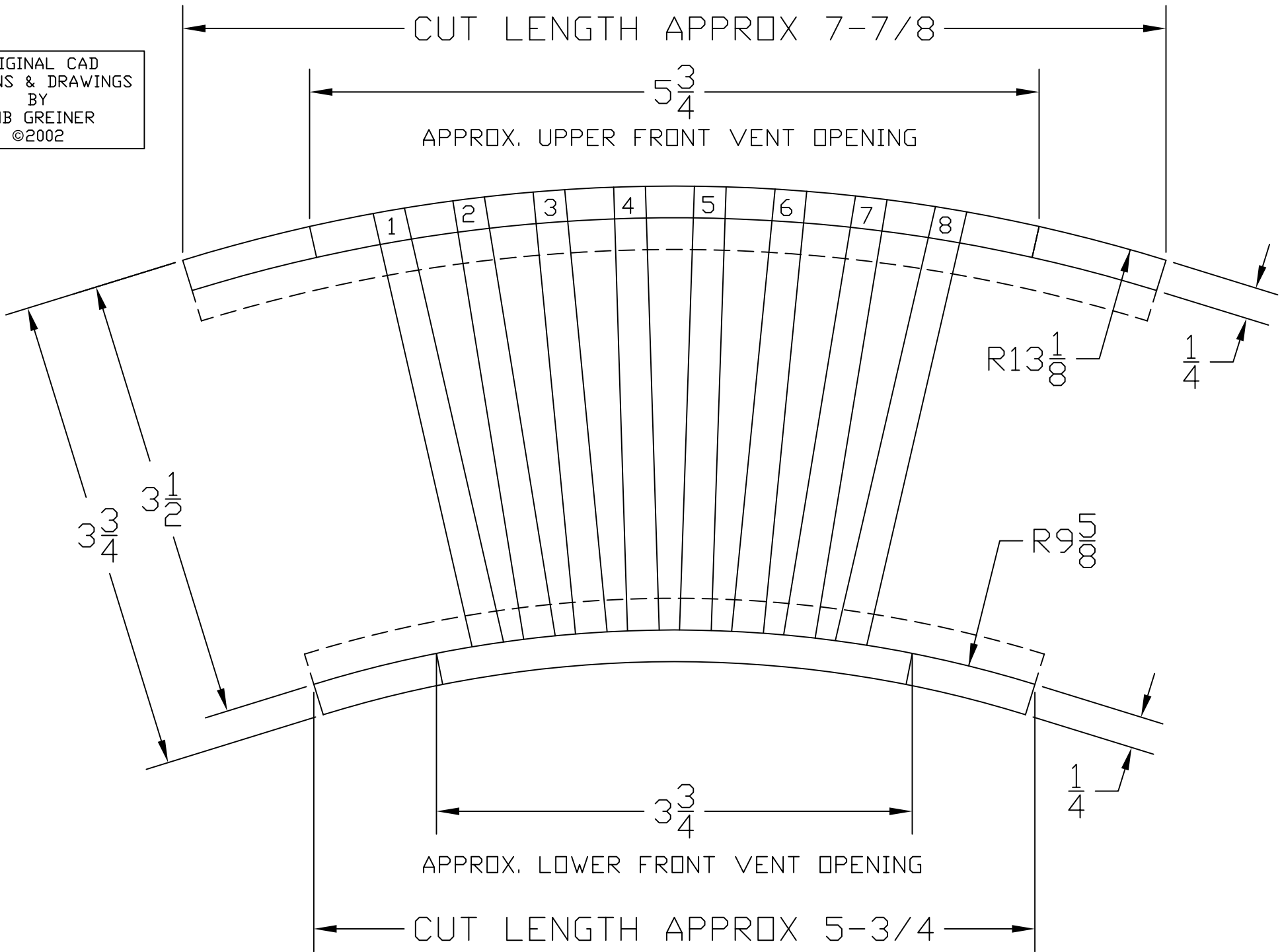

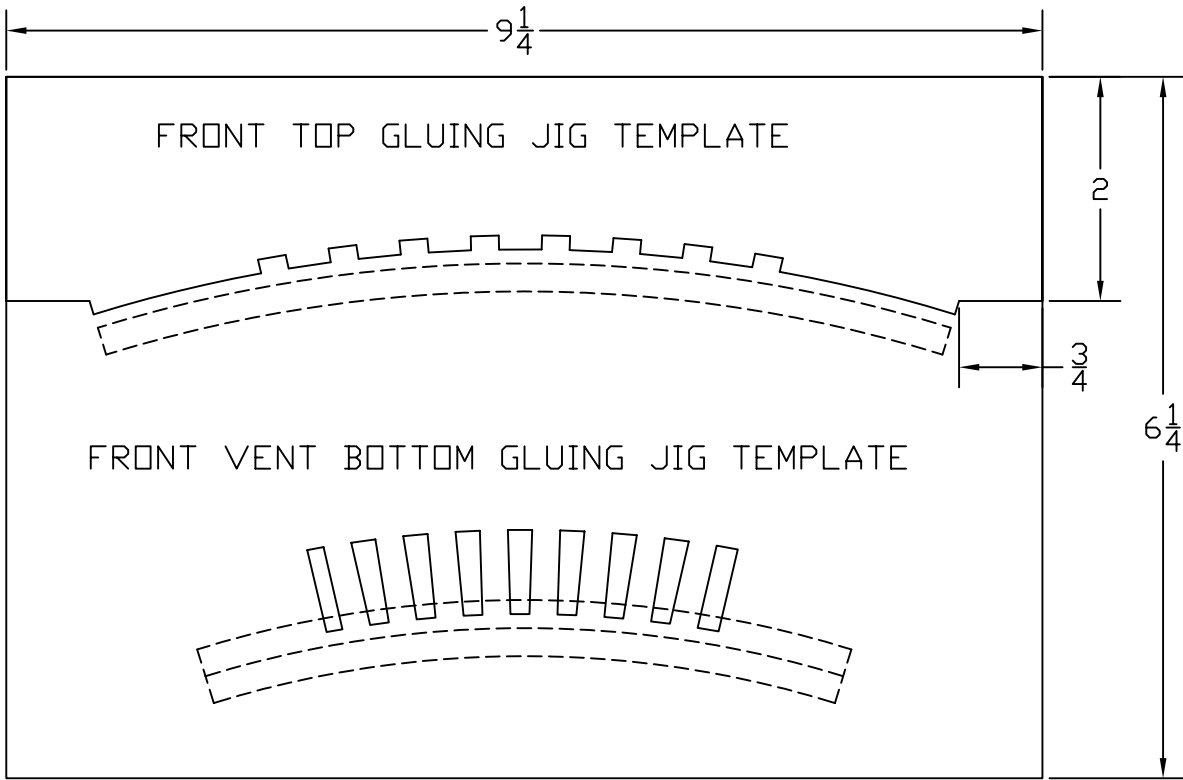

ORIGINAL CAD
 DESIGNS & DRAWINGS
 BY
 BOB GREINER
 ©2002

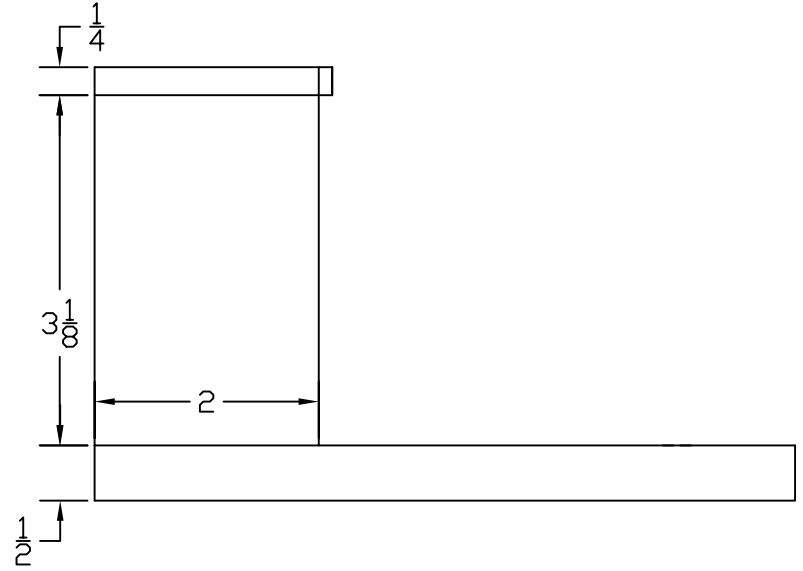
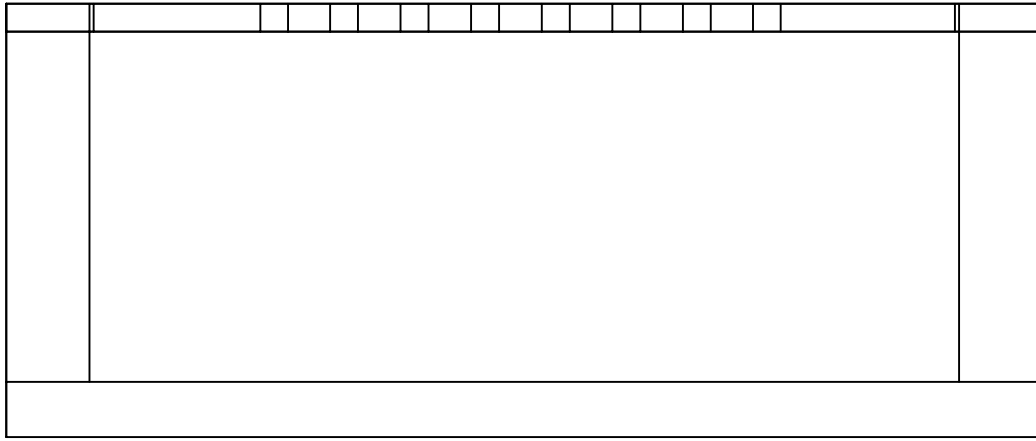

$9\frac{1}{4}$

FRONT TOP GLUING JIG TEMPLATE

2

ORIGINAL CAD
DESIGNS & DRAWINGS
BY
BOB GREINER
©2002

$\frac{3}{4}$

FRONT VENT BOTTOM GLUING JIG TEMPLATE

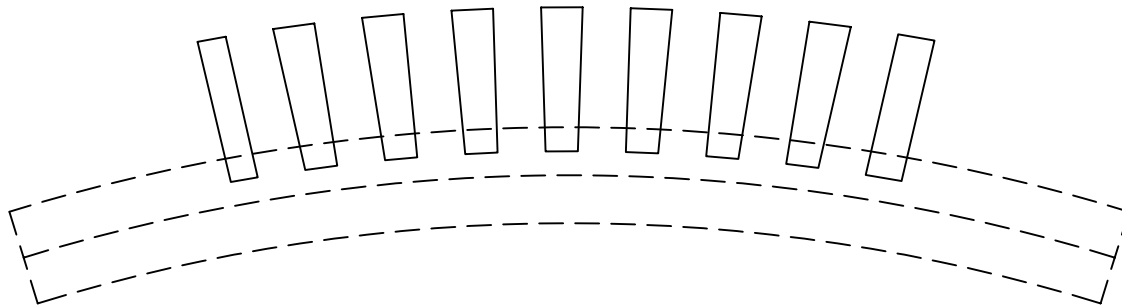

9 ¹/₄

FRONT TOP GLUING JIG TEMPLATE

2

3 ³/₄

6 ¹/₄

FRONT VENT BOTTOM GLUING JIG TEMPLATE

ORIGINAL CAD
DESIGNS & DRAWINGS
BY
BOB GREINER
©2002

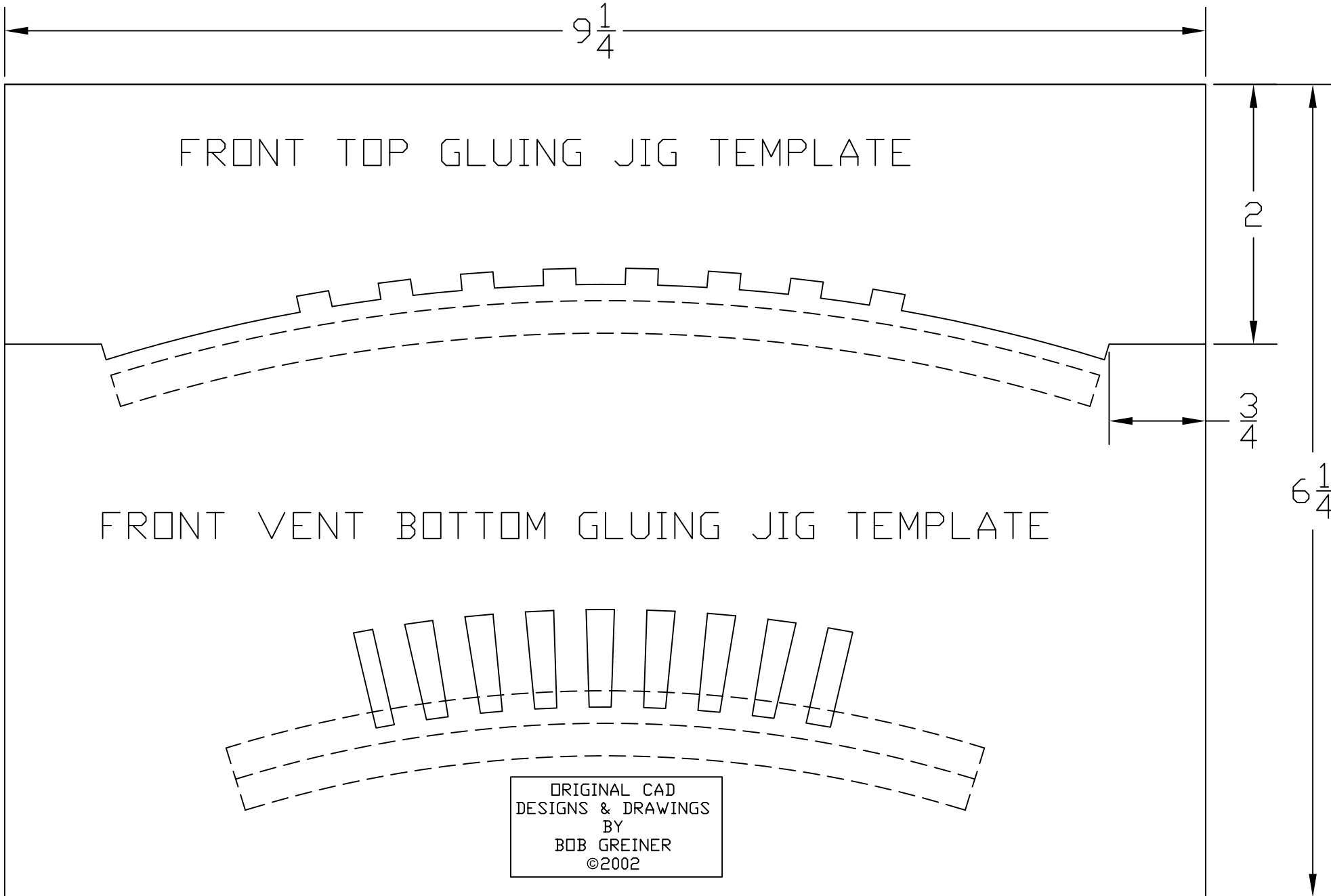

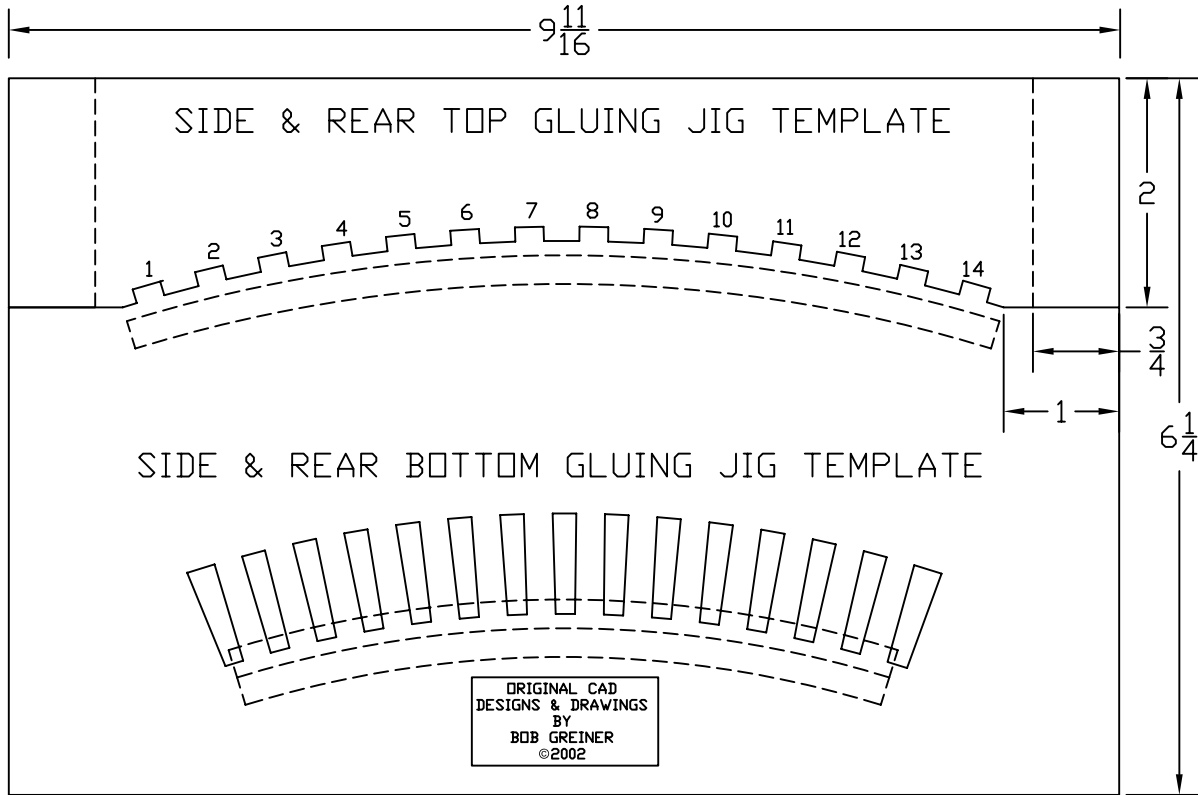

ORIGINAL CAD
 DESIGNS & DRAWINGS
 BY
 BOB GREINER
 ©2002

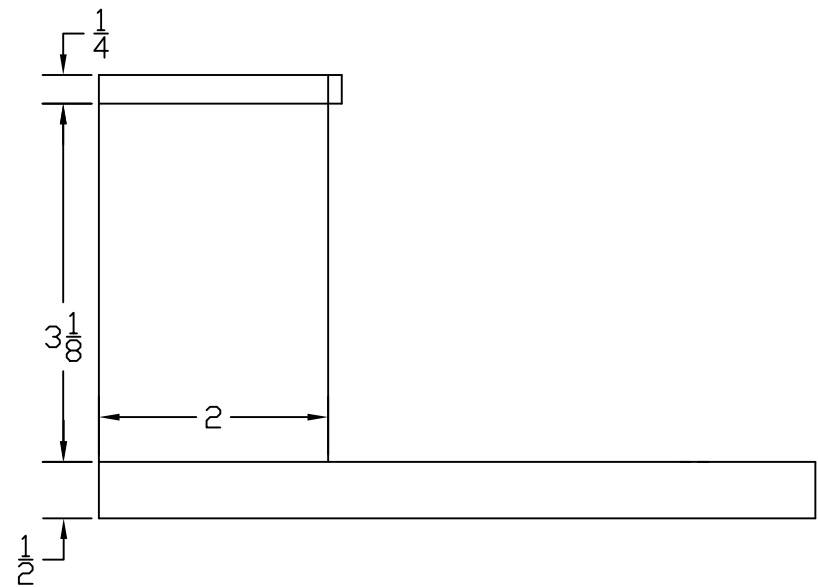
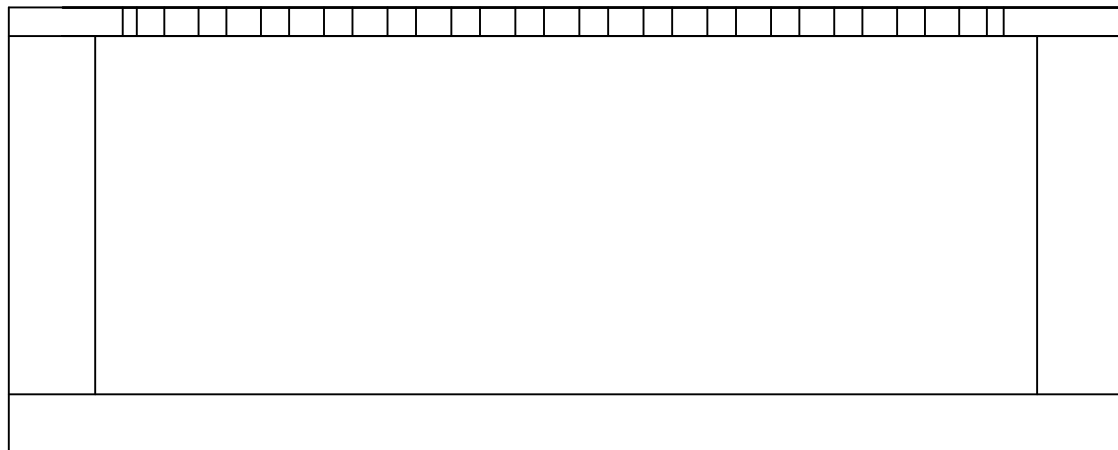

$9\frac{11}{16}$

SIDE & REAR TOP GLUING JIG TEMPLATE

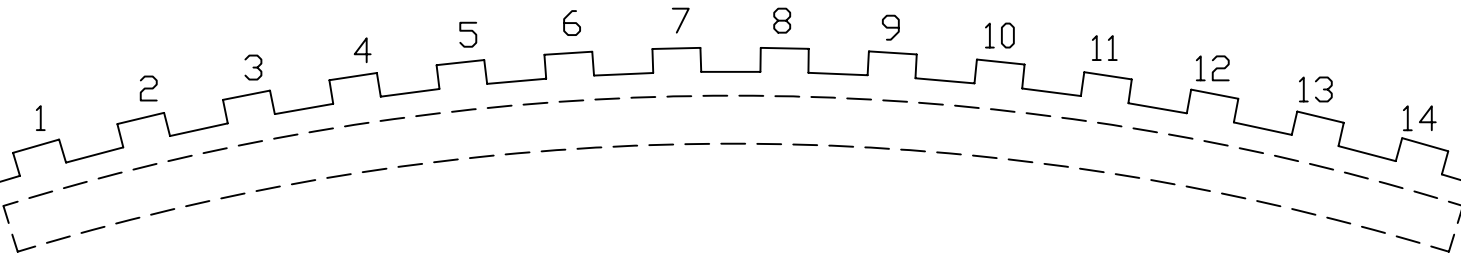

2

$\frac{3}{4}$

1

$6\frac{1}{4}$

SIDE & REAR BOTTOM GLUING JIG TEMPLATE

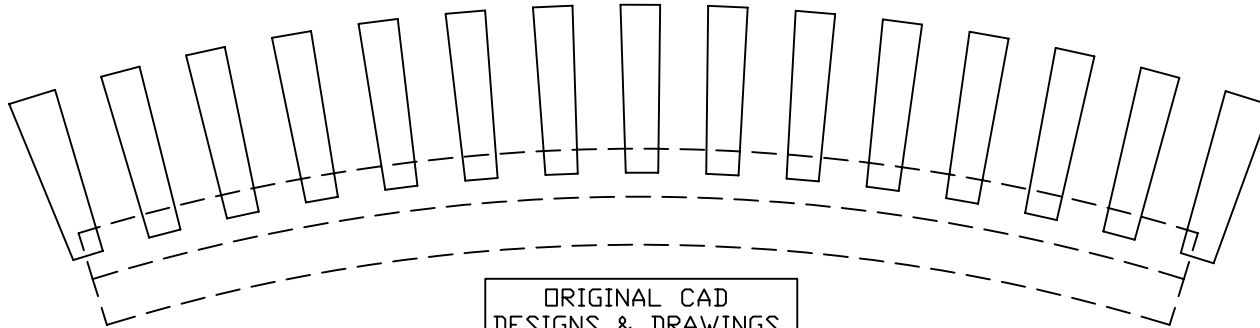

ORIGINAL CAD
DESIGNS & DRAWINGS
BY
BOB GREINER
©2002

LOWER VENT RAIL TEMPLATE (B)
MAKE 4 RAILS

ORIGINAL CAD
DESIGNS & DRAWINGS
BY
BOB GREINER
©2002

MAKE 1 CUT ON THIS LINE

R9
500

STRAIGHT CUT LENGTH OF
PLASTIC = 5-3/4"

LOWER VENT RAIL TEMPLATE (A)

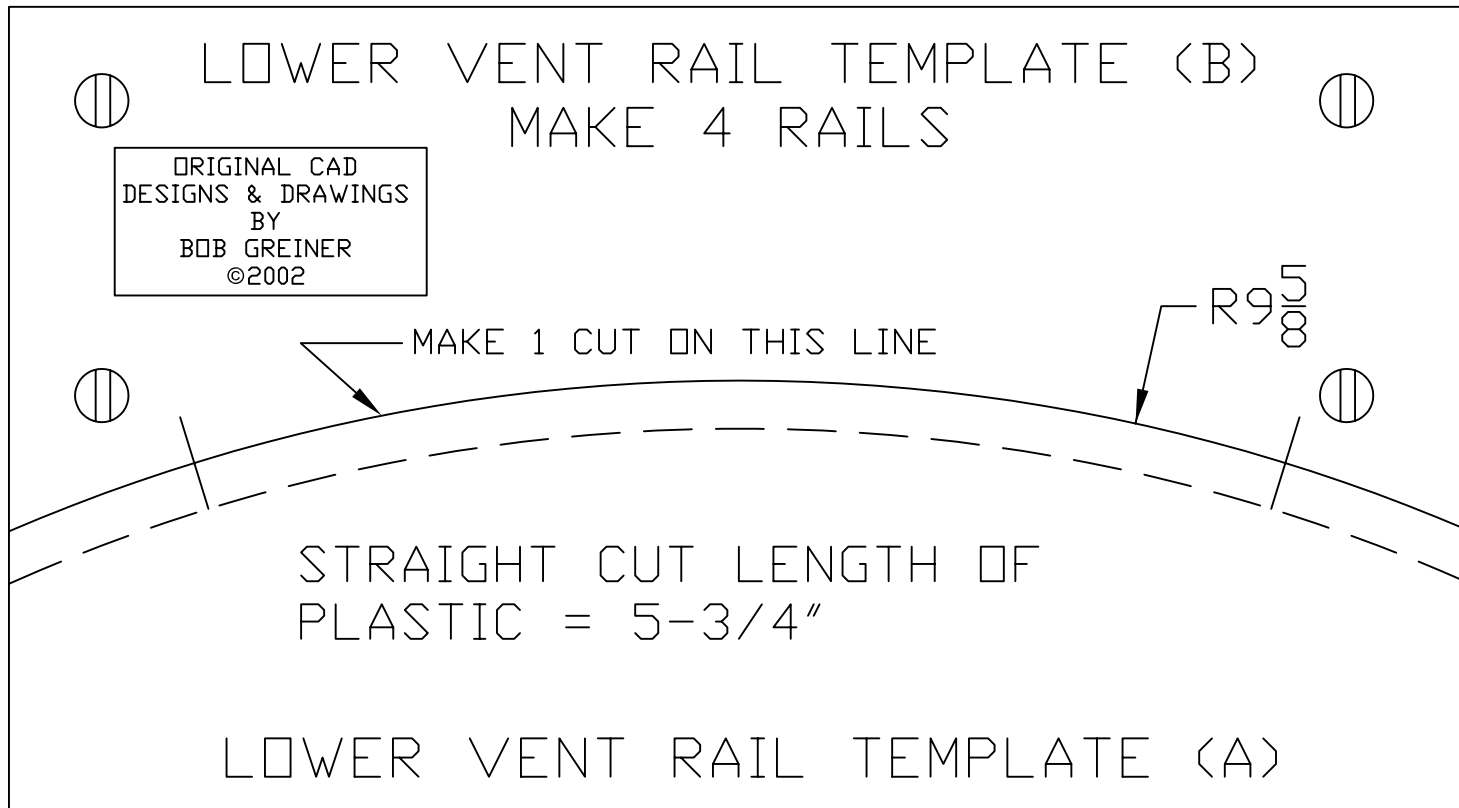

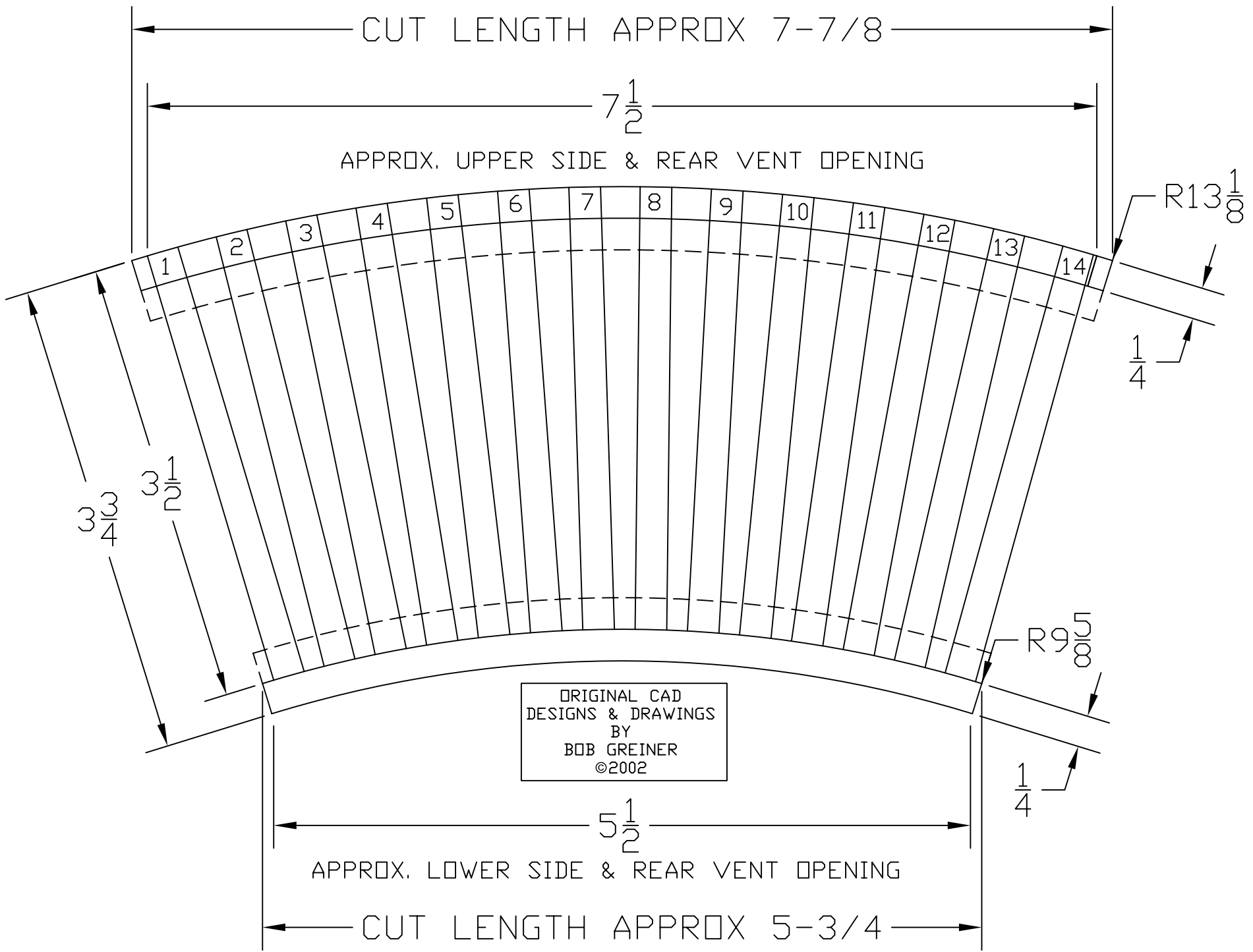



UPPER VENT RAIL TEMPLATE (B)
MAKE 4 RAILS



ORIGINAL CAD
DESIGNS & DRAWINGS
BY
BOB GREINER
©2002

MAKE 1 CUT ON THIS LINE

R13 $\frac{1}{8}$

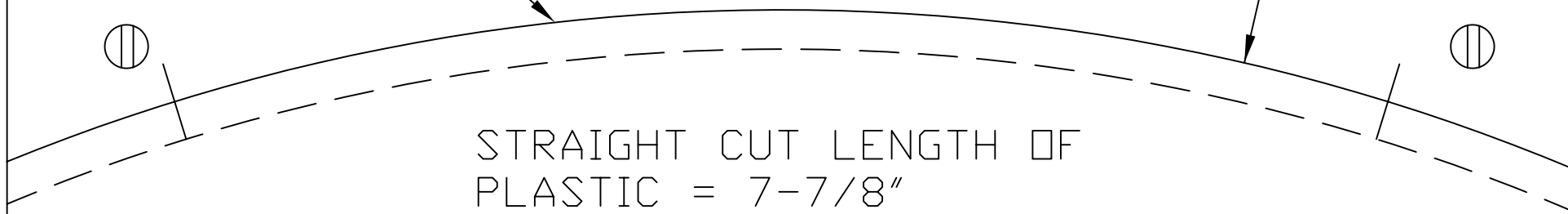

STRAIGHT CUT LENGTH OF
PLASTIC = 7-7/8"

UPPER VENT RAIL TEMPLATE (A)

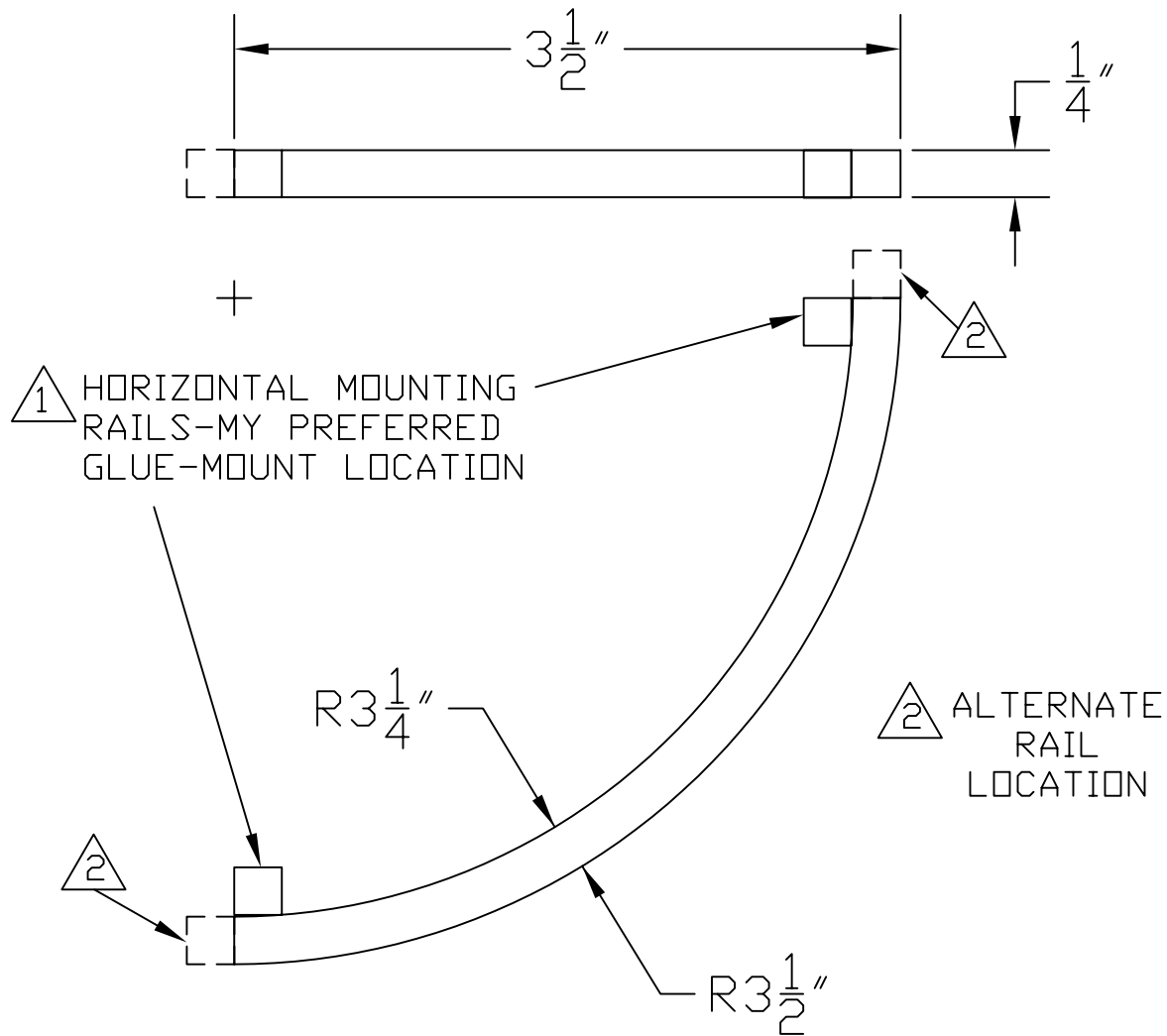

① I HAVE CHOSEN THIS METHOD (MY PREFERRED) OF POSITIONING THE HORIZONTAL RAILS BECAUSE IT PROVIDES EASIER LESS CRITICAL JOINTS TO MAKE. USING GOOP TO GLUE THEM (INSTEAD OF SOLVENT CEMENT) WILL ALLOW SOME STRESS RELIEF ON THE FINISHED ASSEMBLY & WILL FILL ANY GAP IN THE JOINTS.

ORIGINAL CAD
 DESIGNS & DRAWINGS
 BY
 BOB GREINER
 ©2002

ORIGINAL CAD
DESIGNS & DRAWINGS
BY
BOB GREINER
©2002

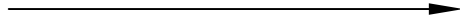

VENT RIB TEMPLATE
(SLIDER)

STRAIGHT CUT LENGTH OF
PLASTIC = 5-3/8"
MAKE 50 RIBS

VENT RIB TEMPLATE
(FIXED)

